

UNDERCOVER

be anything.

EN



Structure

Structure	6
Advantages	6
The body	7
The roof	8
The skin	11

Parts

Parts	14
Level and stabilize on hard surface	14
Stabilization by anchoring	16

Packs

Standard packs	20
Single or double UnderCovr	20
Alternative set-ups	21

The world of live communication continues to evolve. With this new concept you can **take your beMatrix stock beyond the show floor and go outdoors.** With the addition of just a few new parts, you open up a world of new opportunities. Use your existing beMatrix inventory and take the convenience of our system outdoors.

Outdoor events are nothing new, but with this new concept you take the ease of use the beMatrix system is known for, anywhere.

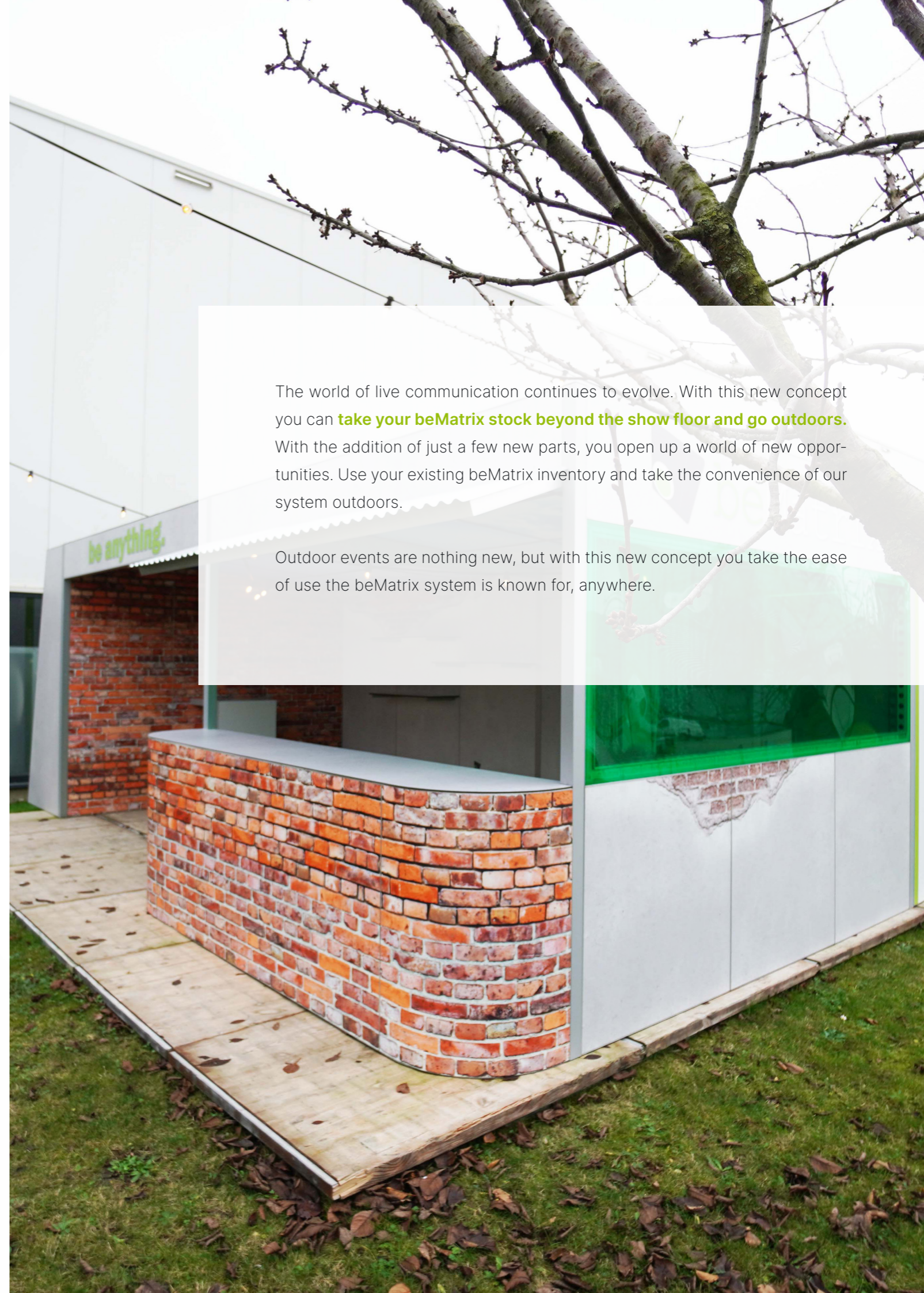



01

Structure

Structure

Advantages

One integrated solution

With UnderCovr you no longer need to setup tent structures to cover your beMatrix frames. This type of work-around is now a thing of the past. UnderCovr is a **single structure** that offers sufficient strength and outdoor durability on its own.

Build fast

Just like with our other products, assembling with UnderCover is lightweight and fast. Thanks to the big holes, the frames can easily be connected to each other without needing any tools.



beMatrix DNA

The core of beMatrix is innovation and modularity, and UnderCovr is no different. UnderCovr can be combined with all other beMatrix products both inside and outside, giving designers true design freedom.

Get creative

You choose how the UnderCovr will look. As with all our products, you can finish the UnderCovr with 3 mm panels or SEG textile that fit the standard b62 frames.



The body

The walls of the module are built with standard beMatrix frames and connectors. You can reuse your current beMatrix inventory or get your UnderCovr standard pack.

	MODULE 3 X 3	MODULE 6 X 3
	6 standard frames 992 × 2480 mm ECO+ finish Double hook Velcro	6 standard frames 992 × 2480 mm ECO+ finish Double hook Velcro
	3 specific frames 992 × 2294 mm ECO+ finish Double hook Velcro	6 specific frames 992 × 2294 mm ECO+ finish Double hook Velcro
	1 reinforced top frame, D30 holes 310 × 2976 mm ECO+ finish Double hook Velcro	3 reinforced top frames, D30 holes 310 × 2976 mm ECO+ finish Double hook Velcro



GOOD TO KNOW

The ECO+ finish of the frames is a brushing technique, which does no damage whatsoever, to the environment and results in ECO frames that look almost identical to anodised frames.

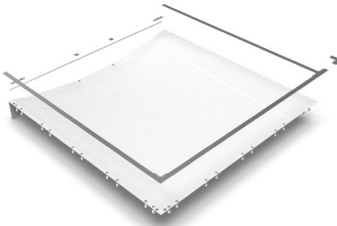

The roof

We have 2 roof sets containing all elements you need to complete the build of the UnderCovr module.
The ceiling is constructed out of standard frames and mounted with standard connectors (ECO+ finish & Double hook Velcro).

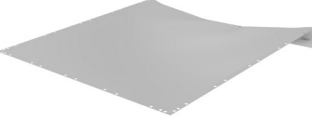
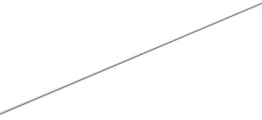
460 000 01 ROOF SET		
	<p>The roof set with dimensions 3 × 3 is mounted on top of the frames at an angle so that water flows to the backside of the construction.</p> <p>The set consists of:</p>	
	Fixation plates to mount the roof cover to the structure with M8 screws. The items are galvanised and painted gray for a nice looking finish. It's possible to attach straps to the ground.	460 03 00 460 03 01 460 03 02 460 03 03 460 03 04
	Roof UnderCovr canvas to shield the inner surface from the rain. The canvas has prepared holes for ease of use.	460 02 00 3100 × 3100 mm RAL 9016
	Roof UnderCovr stabilizer to put tension on the canvas. The rod will make sure the canvas stays put under windy circumstances.	802 2976 D00 Galva D17,2 / 12,5 2976 mm

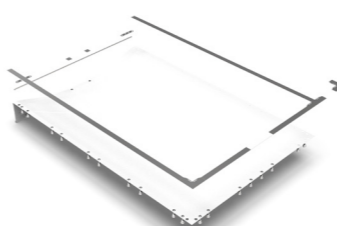
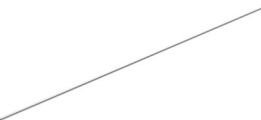

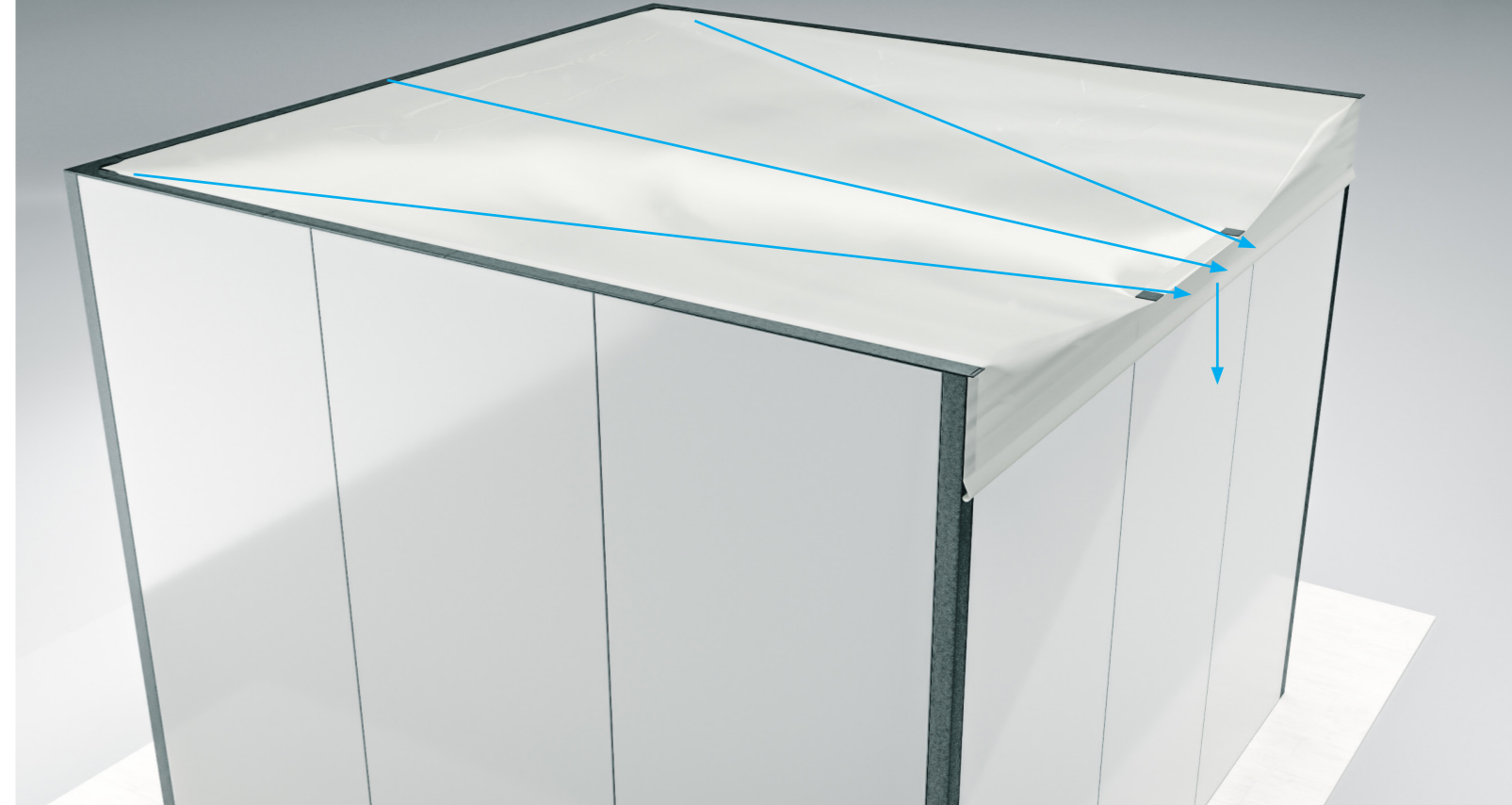

460 000 02 ROOF SET		
	<p>The roof set with dimensions 3 × 2 is mounted on top of the frames at an angle so that water flows to the backside of the construction.</p> <p>The set consists of:</p>	
	Fixation plates to mount the roof cover to the structure with M8 screws. The items are galvanised and painted gray for a nice looking finish. It's possible to attach straps to the ground.	460 03 00 460 03 01 460 03 02 460 03 03 460 03 04 460 03 05
	Roof UnderCovr canvas to shield the inner surface from the rain. The canvas has prepared holes for ease of use.	460 02 02 2108 × 3100 mm RAL 9016
	Roof UnderCovr stabilizer to put tension on the canvas. The rod will make sure the canvas stays put under windy circumstances.	802 1984 D00 Galva D17,2 / 12,5 1984 mm

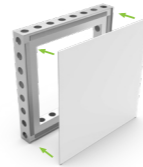

The skin

You can finish the structure by using both printed panels or printed textiles to fit your outdoor event concept. UnderCovr is 100% customizable.



PANELS	TEXTILE	ALTERNATIVE INFILLS
 <p>Panels in PVC, dibond, wood, (acrylic) glass... it's all up to you. Mount panels on both sides of the frame for maximum robustness.</p> <p>Use beMatrix loop & hook Velcro to make sure your panels can withstand the outdoor elements.</p>	 <p>Use textile if you are looking for a seamless finish and the most sustainable solution.</p> <p>For outdoor use, the textile fixation clip (460 05 01) is used to mount and keep the textile in place. With this extra piece, the tendon of the textile is clamped for extra fixation.</p> 	 <p>Almost any other kind of material - even thicker than 3 mm - can be mounted onto the beMatrix frame system.</p> <p>Go loose and think alternatives: (fake) moss, wood, Alcantara tiles, rope, plexi... What do you have in mind?</p>



02 Parts

Parts

Level and stabilize on hard surface

UnderCovr's parts let you take your current beMatrix inventory outdoors. You can build covered surfaces of 3 × 3, 6 × 3 or 3 × 2 and place as many modules next to each other as you need. No matter what surface you place the modules on, we've got you covered. You can stabilize the UnderCovr on hard surfaces using the frame counter weight, or anchor the module in the ground. **Underneath an example of a 6 × 3 structure** with the needed parts.



Frame counterweight

901 60 01

A 18 kg galvanized steel counterweight **to strengthen all types of beMatrix indoor and outdoor constructions**. The part is designed to perfectly fit the b62 grid and is easily stackable. In combination with the frame reinforcement bracket, the counterweights are kept in place in a completely invisible way. Add up to 4 weights inside a 992mm wide frame. Can also be used to counterweight a LEDskin® wall by adding it to a 90° return frame. For indoor and outdoor use.

Roof underCovr canvas

460 02 00

Fixation plate

460 03 00
460 03 01
460 03 02
460 03 03
460 03 04



b62 reinforced frame

640 0310 2976 30

b62 frame

606 +++++ +++++ 30

Adjustable foot XL M8

901 39 01

Level your UnderCovr structure by mounting the adjustable XL foot with M8 thread in a pin under the frame or in combination with **the square 62 base plate connector. 901 34 615 D30 GALVA.**

20 - 90 mm



Frame reinforcement bracket

901 60 02

When adding the frame reinforcement bracket, you add extra strength to the frame. **The bracket will prevent torsion at the bottom** or the weakest point of the frame when adding one or more frame counterweights. On top, the bracket keeps the counterweights in place in an invisible way. Mounted with M8 pin connector or toolless connector. For indoor and outdoor use.

Stabilization by anchoring



Ground anchor

460 04 00

Fix the construction to the ground with an anchor for more stability, preferably to be used in combination with the base plate 460 06 00.

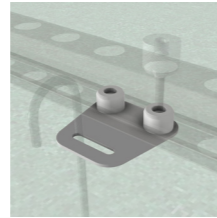

Ground anchor plate

460 06 00

Don't damage your frames by using the ground anchor plate. This base plate is used to fix the construction to the ground by means of ground anchor 460 04 00.

STRAP (7,5 × 25 mm) grey

990 60 24 14

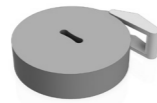

Good to know

The UnderCovr module complies with the **EN 13782** standard.

- The certified module contains a setup using the combination of **hard surface stabilization** and anchoring.
- The structure can withstand windspeed of **max 80 km/h**
- The roof surface can carry a **snow load less than 8cm**
- The structure can have a **maximum width of 10m** and a surface less than 50m²
- To comply with the standard, a reinforced top frame is needed.

If the event or customer does not require compliance with this maximum windspeed, you can delete some items such as straps or reinforcement.

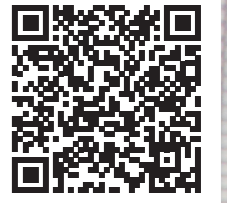



03 Packs

Standard packs

Single or double UnderCovr

We bundled the UnderCovr elements and features into **2 standard UnderCovr Packs**.

Each pack offers you:

- Complete UnderCovr set-up including frames, parts and canvas. Excluding panels.
- Fast set-up and dismantling
- Light and user-friendly
- Standard eco-finish profiles
- Certified construction according to EN 13782

460 001 TG

3 × 3

3100 × 3100 × 2480 mm

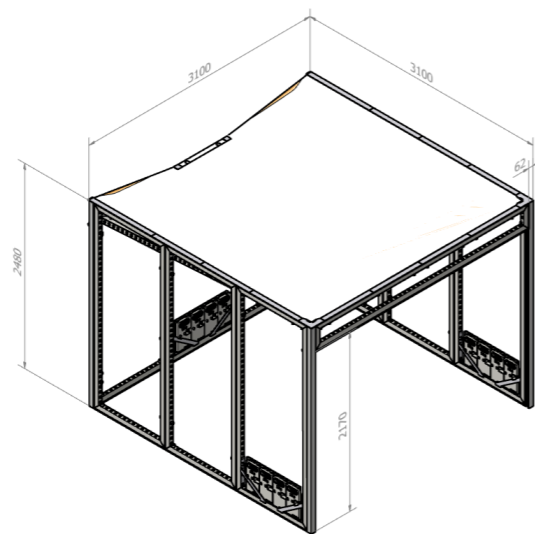

460 000 TG

6 × 3

6138 × 3100 × 2480 mm

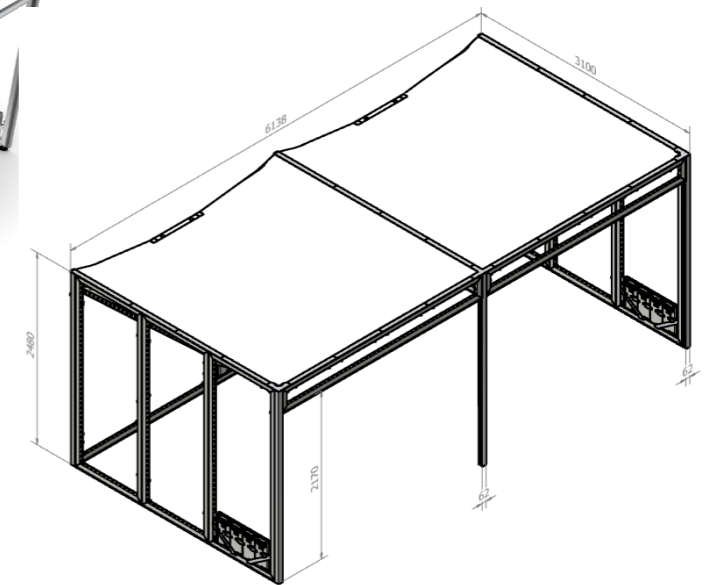

Alternative set-ups





be strong <> be stylish
be anything.

Come say hi

HQ Belgium
Wijnendalestraat 174
8800 Roeselare

get in touch

+32 (0)51 20 07 50
info@beMatrix.com

or boost your inspiration

www.beMatrix.com
socials @beMatrix
f t in o v