

How to...

Textile infills

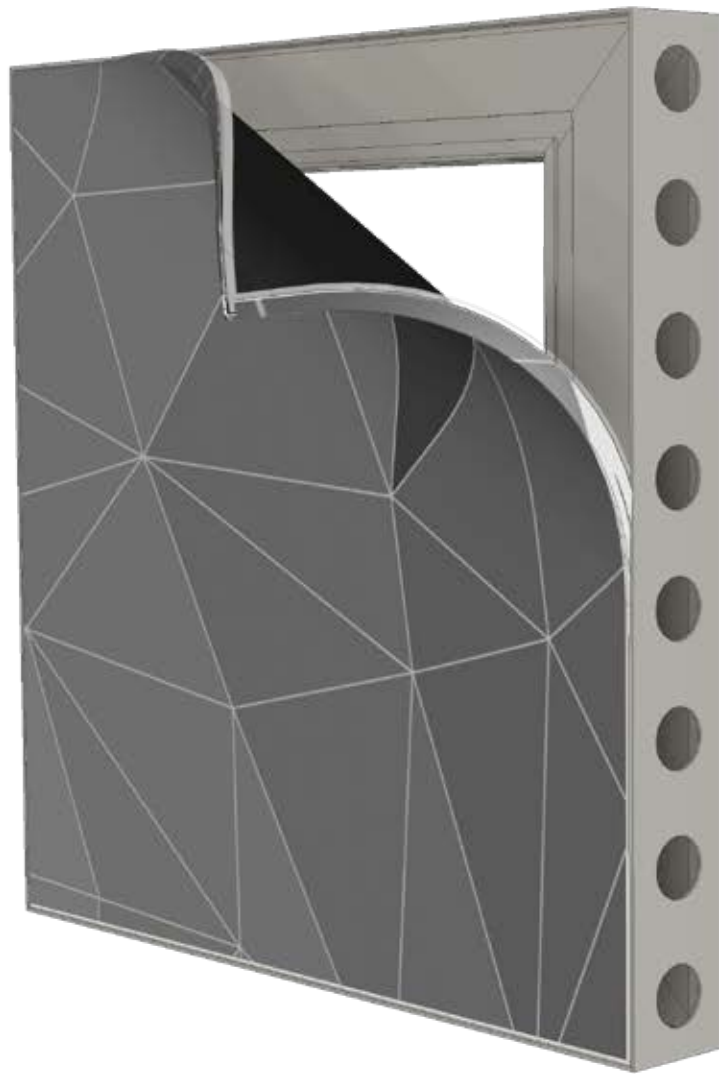

beMatrix[®]
re!nventing stand building systems

INDEX

Chapter overview

How to...	Order textile	3
How to...	Supply graphics files for textile printing	4
How to...	Determine textile dimensions	5

How to...

Order textile

To ensure a perfect match of the infill with the beMatrix frame, giving as much information as possible to the textile supplier is key.

We advise you to send the following information with your request:

- First and foremost, specify that the textile will be used on the beMatrix frame system.
- Specify the exact dimensions of the frame: 992 x 2480 mm instead of 1 m x 2.5 m.
- The use of special profiles in the stand.
- The type of application to determine the type of textile, e.g. blackout fabric, lightbox, LEDskin® , etc.
- Add the technical drawing of the stand, which can be:
 - The technical drawing supplied by beMatrix with your order
- OR
- Your own technical drawing
- OR
- If you do not have a technical drawing, we can make one upon request (€60/hour)
- 3D files of the stand (if available)
- An image of how and where the visual will be integrated in the stand, e.g. visual on a door, on a corner etc.

bePartner • printed textiles

We have selected worldwide partners for textile printing that can offer premium print quality and are very familiar with the beMatrix products. These so-called bePartner • printed textiles will help you to achieve a perfect result.

Find your bePartner on our website:

- For Europe: www.beMatrix.com/nl/bePartners
- For USA: www.bematrix.us/us/partners/



How to...

Supply graphics files for textile printing

To ensure your prints will match your expectations, you need to make sure you supply the basic inputs correctly.

Any deviation from these specifications will result in additional adjustments, at extra costs and might cause a deadline overrun.

When in doubt, please do not hesitate to contact your printing company.

1. File types

- Illustrator .EPS, .AI or Acrobat PDF
- Full color bitmaps, preferably in .TIFF
- Also possible: JPG, Photoshop EPS

Indesign files will only be accepted when accompanied by all fonts and bitmaps. QuarkXPress documents or PowerPoint, Publisher, Word and Excel files are not accepted.

2. Resolution and lay-out

- Digital: to scale 1/10 with min. 600 dpi - max. 1500 dpi
- Vector graphics, full color bitmap or a combination of both (PDF)
- No crop marks, bleed marks, registration marks, etc.
- Convert text to outlines (or supply the fonts)
- Provide a minimum bleed of 15 mm at all sides

3. Colours

- Digital: RGB and CMYK are possible
- Colours will be reproduced differently according to the respective material; printing on textile has its limitations.

In order to guarantee the printed colours will match the colours you envisaged, a colour binding sample (proof print) will be required, using the files you provided. For plain colours, we will need the corresponding PANTONE Coated colour specification. In case no colour specification or sample is supplied, the colours will be printed using the colour data present.

Upon request, we can also print a sample on a material of your choice.

Please send your files via www.wetransfer.com

How to...

Determine textile dimensions

The following pages explain how you can calculate the correct dimensions of the textile infills for your beMatrix frame/door/profile. As a general rule, always start from the frame size.

Please note: these are theoretical dimensions! For the best result, we advise you to supply the (door) frame or profile to your printing company.

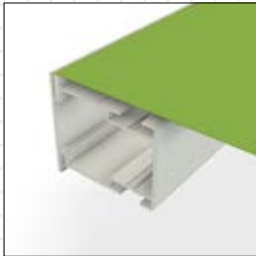

b62 frame

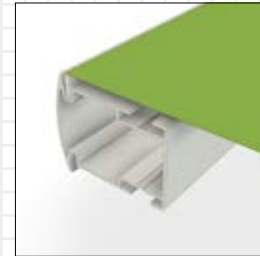
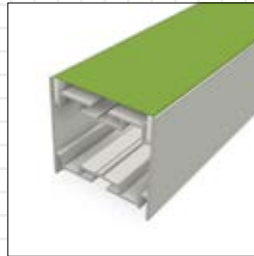

Single & double pivoting door

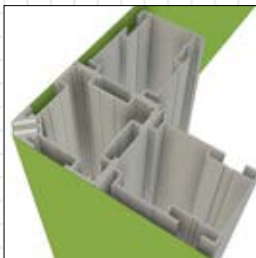

Corner profile (SQ62)

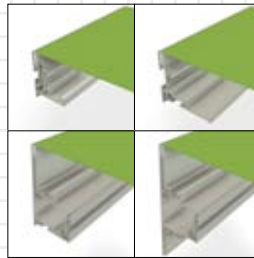

Lightscreen:

- LS55S
- LS62S
- LS124S
- LS186D



Boxscreen:

- 726
- 727
- 728

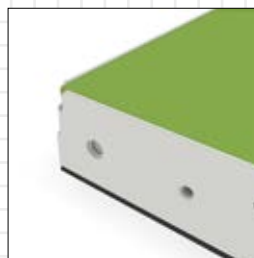

LEDskin® MKII



Fixscreen (FS20S)

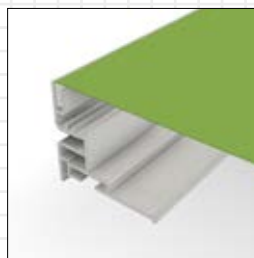

MOTIONskin®

How to...

Determine textile dimensions

b62 frame (606 +++++ +++++)

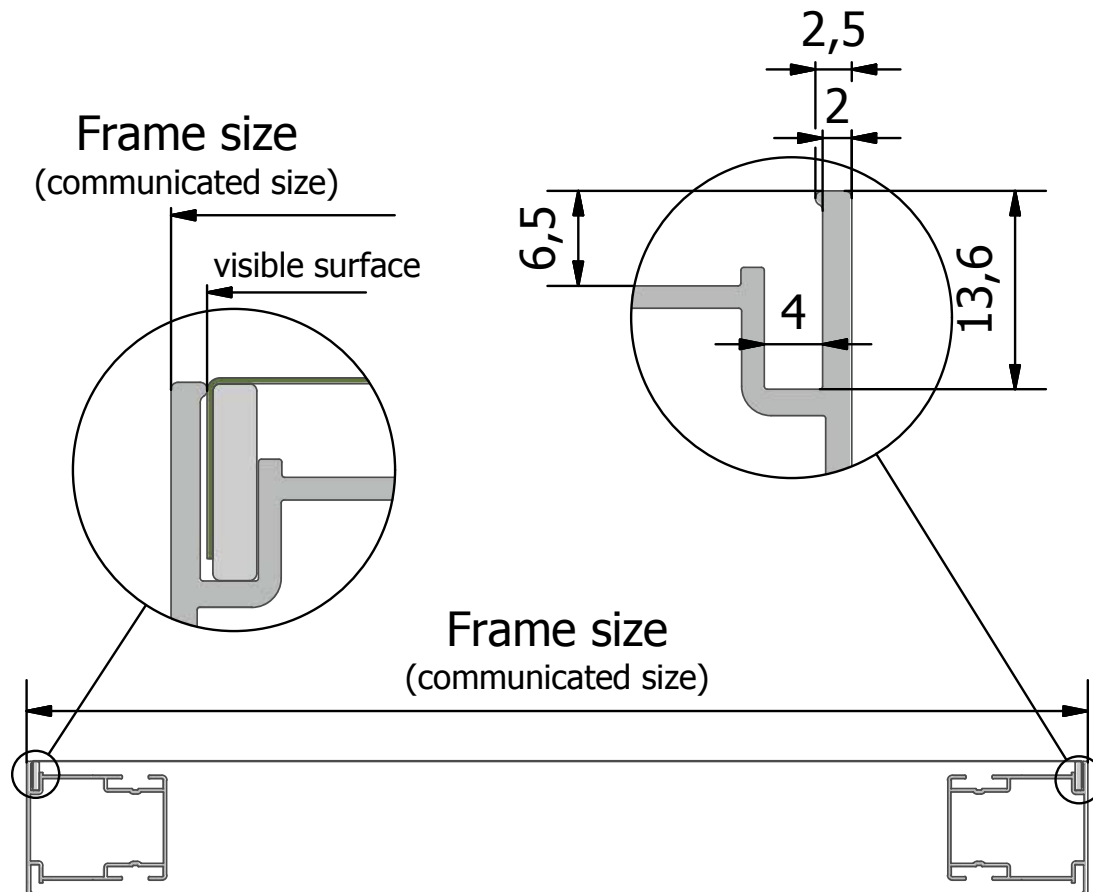

How to...

Determine textile dimensions

Textile Square 62 (614)

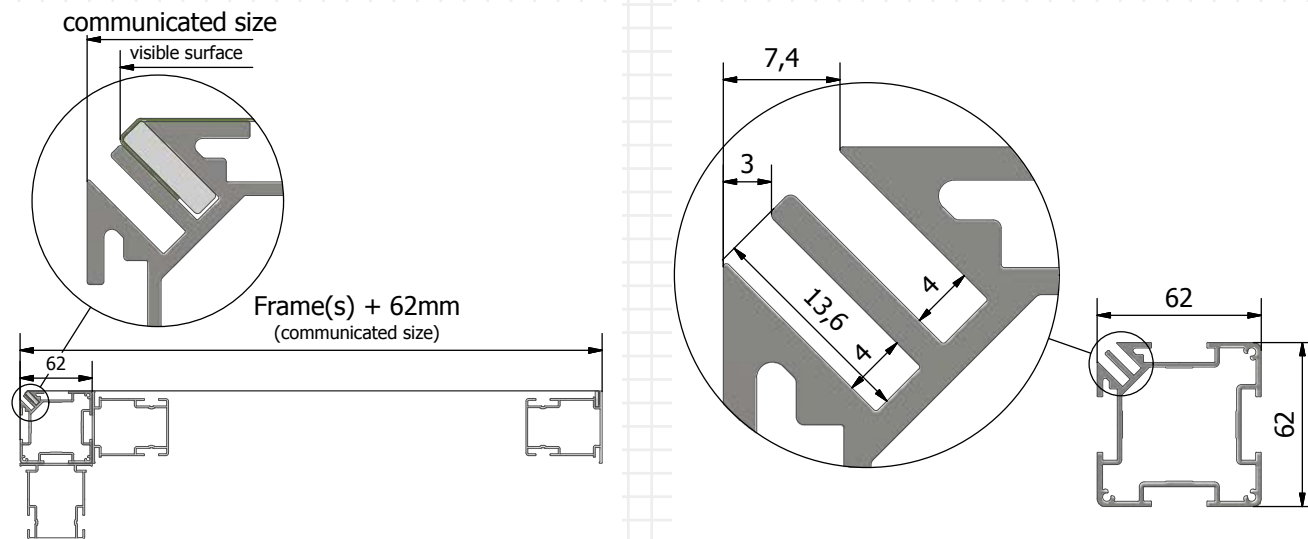

How to...

Determine textile dimensions

Boxscreen (726)

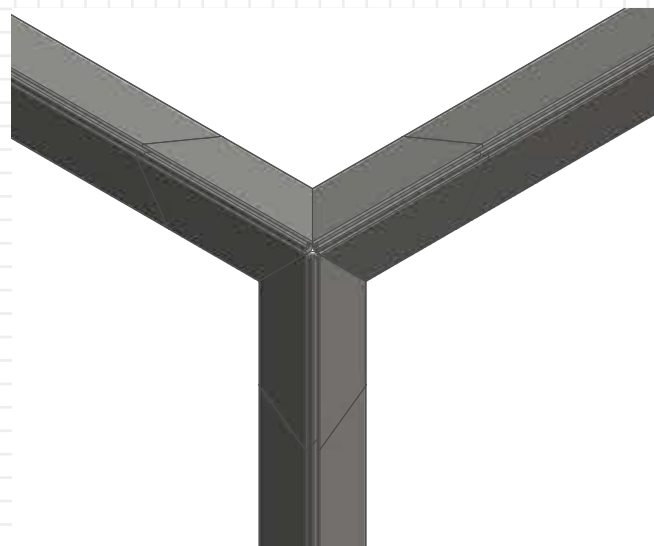
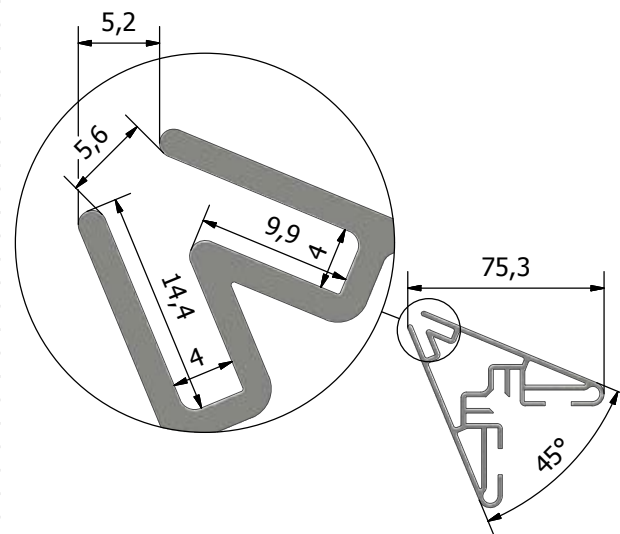
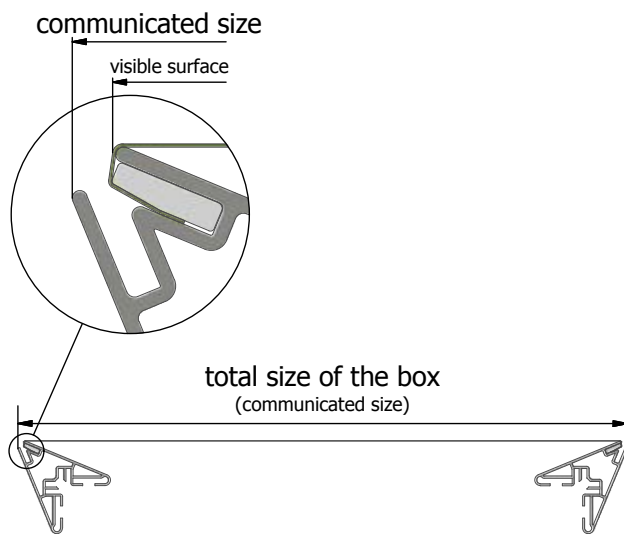

How to...

Determine textile dimensions

Boxscreen (727)

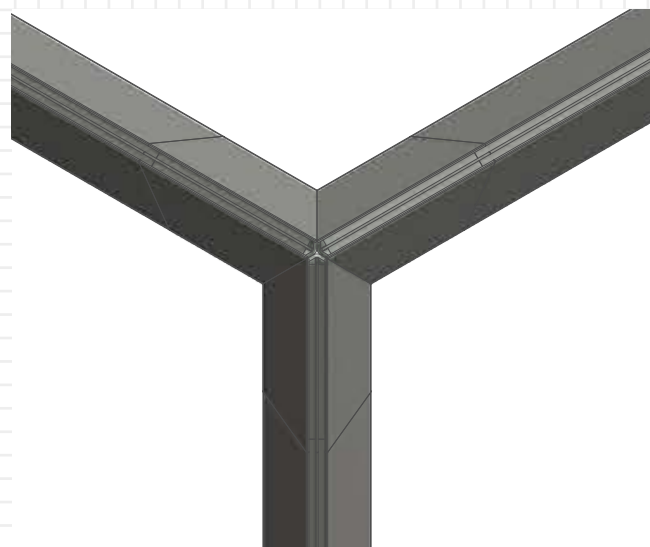
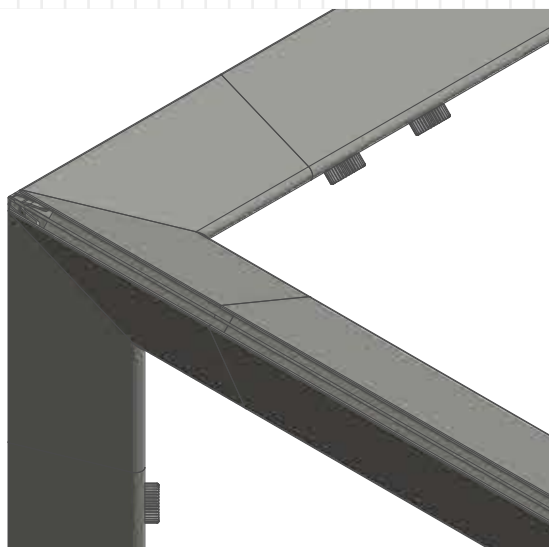
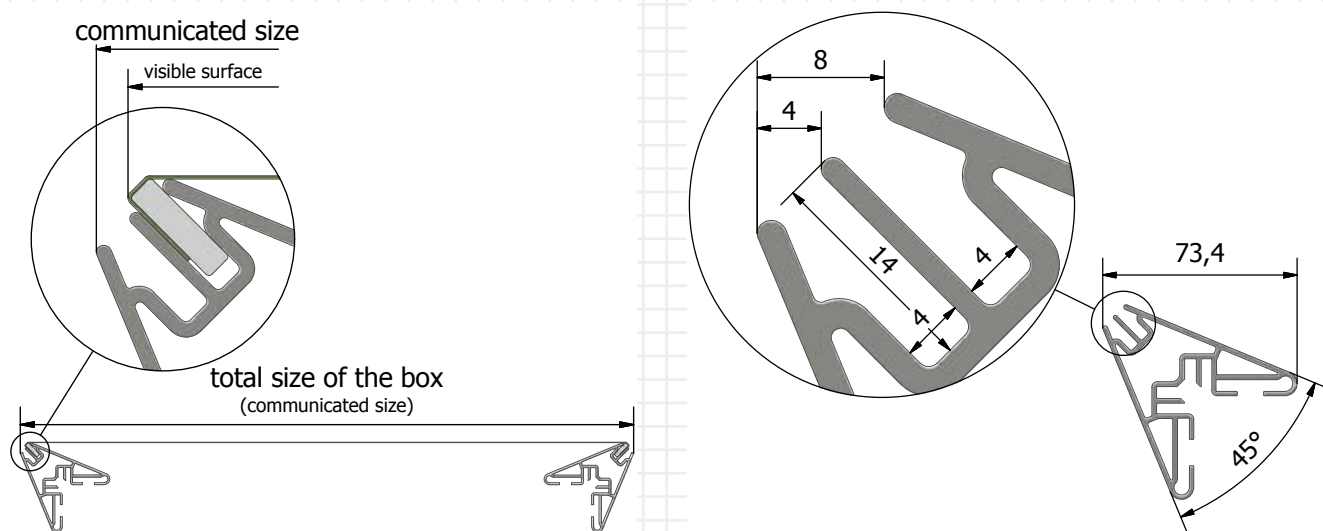

How to...

Determine textile dimensions

Boxscreen MINI (728)

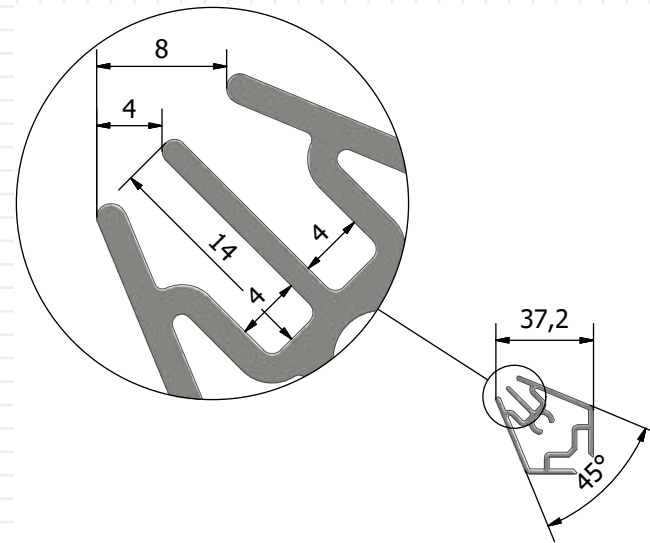
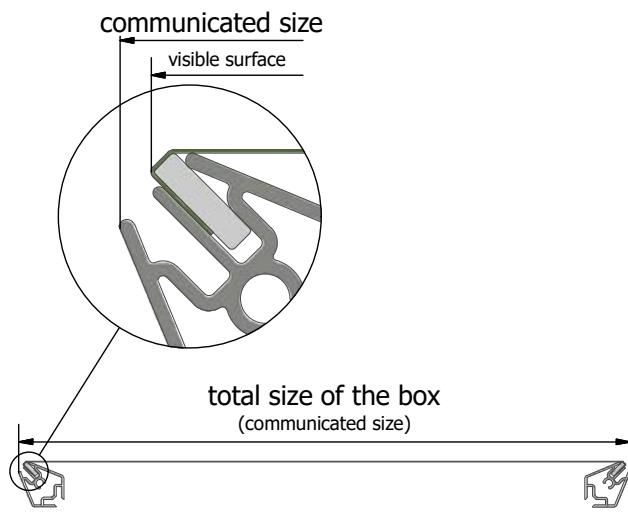

How to...

Determine textile dimensions

Fixscreen FS20S (711)

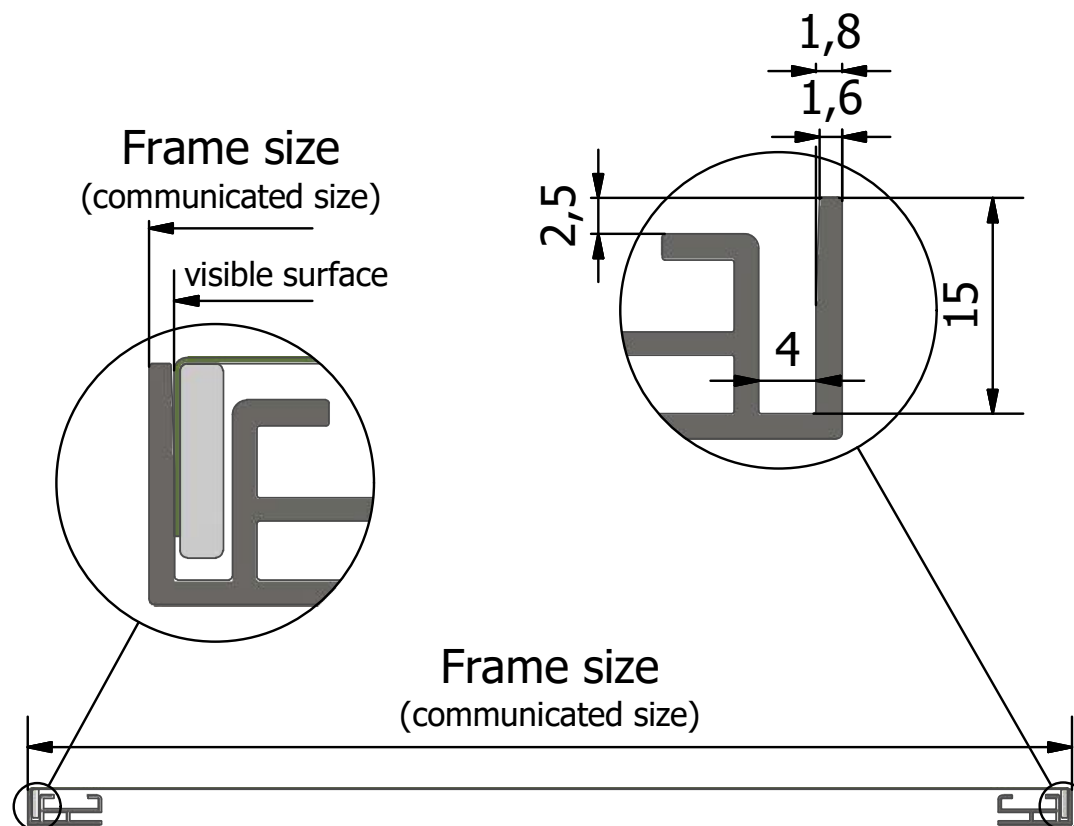

How to...

Determine textile dimensions

Pivoting door (620 0992 +++)
without lock

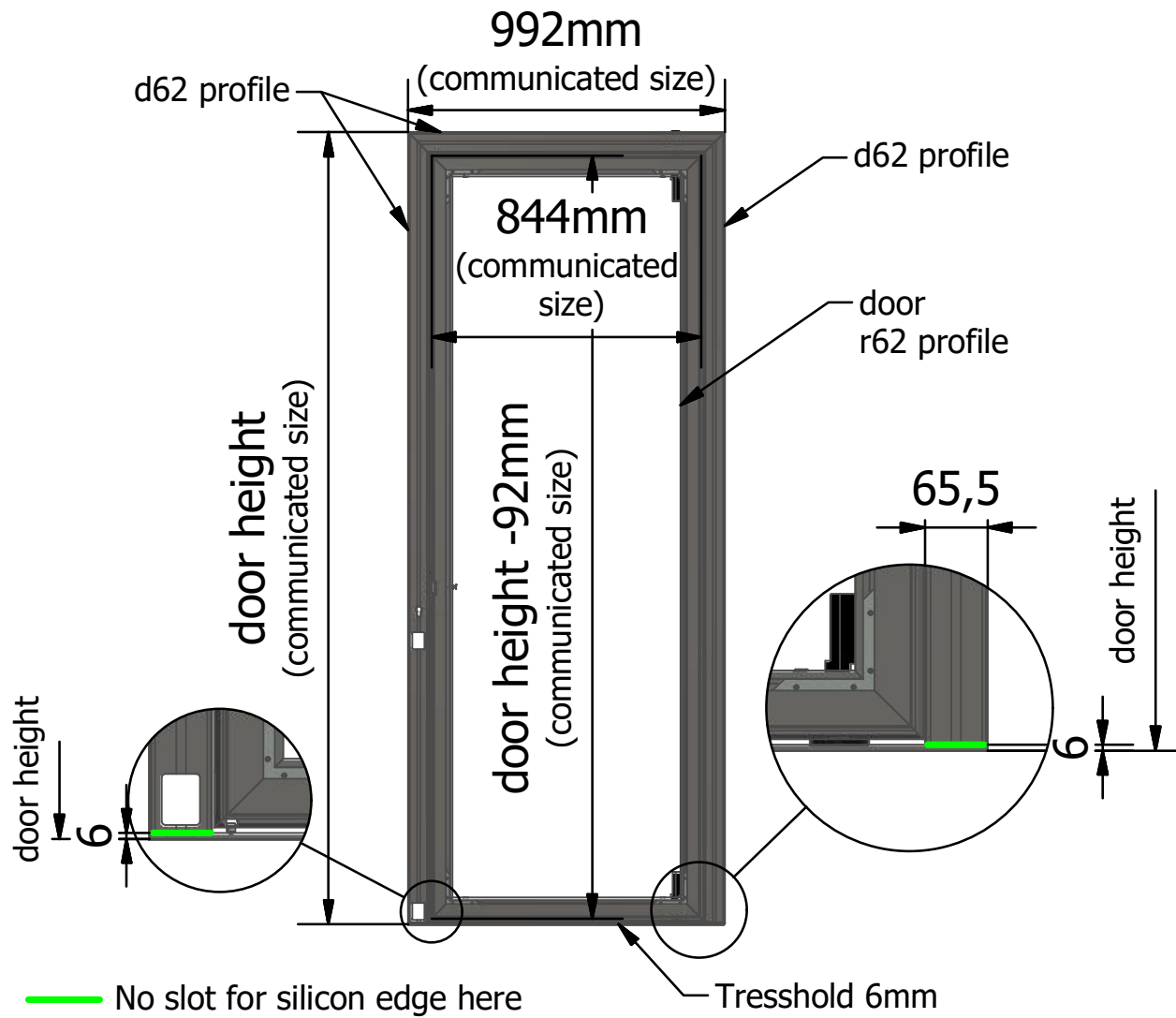

How to...

Determine textile dimensions

Pivoting door (620 0992 +++)
with a bottom-mounted lock

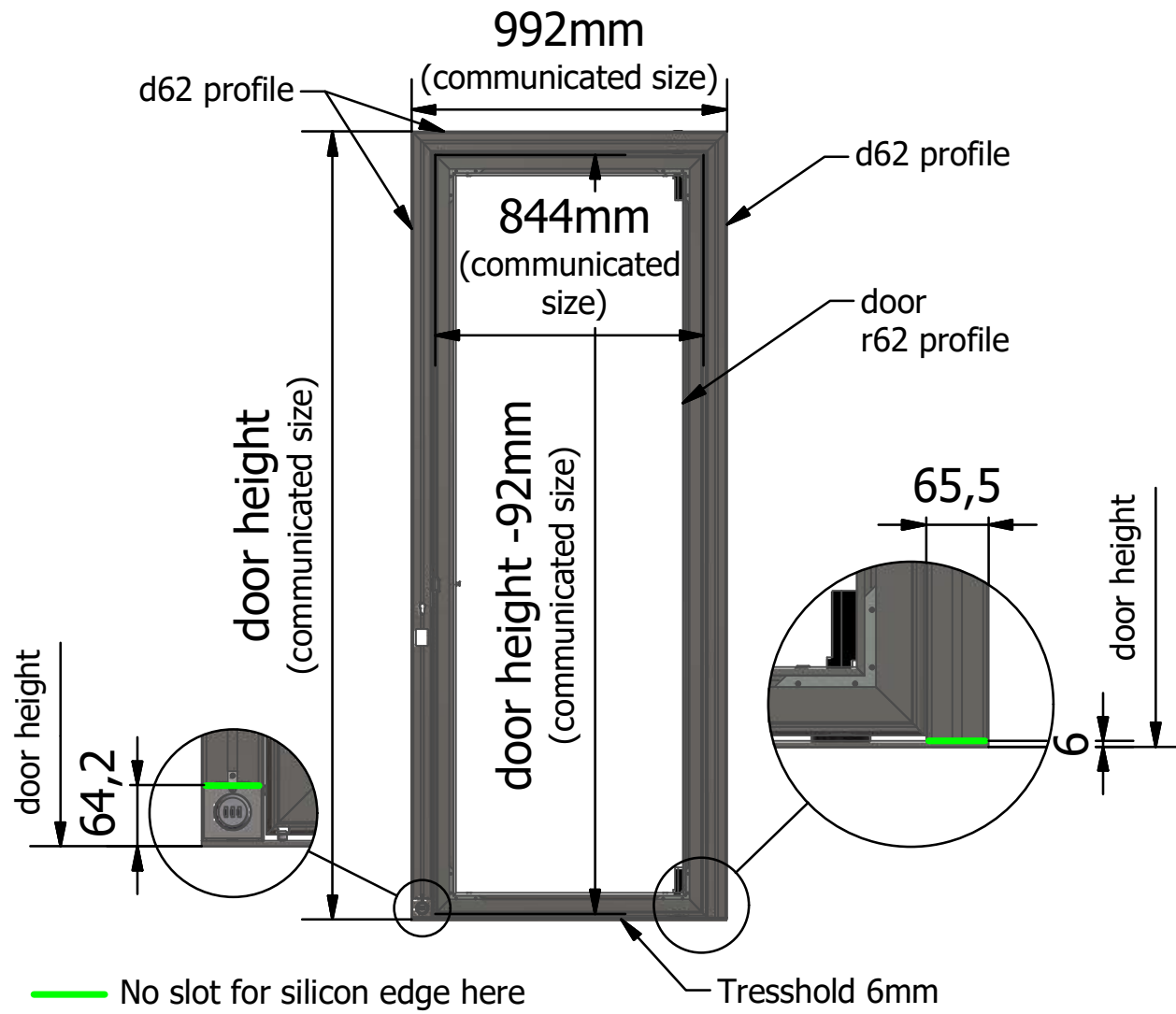

How to...

Determine textile dimensions

Pivoting door (620 0992 +++)
with a lock mounted in the centre

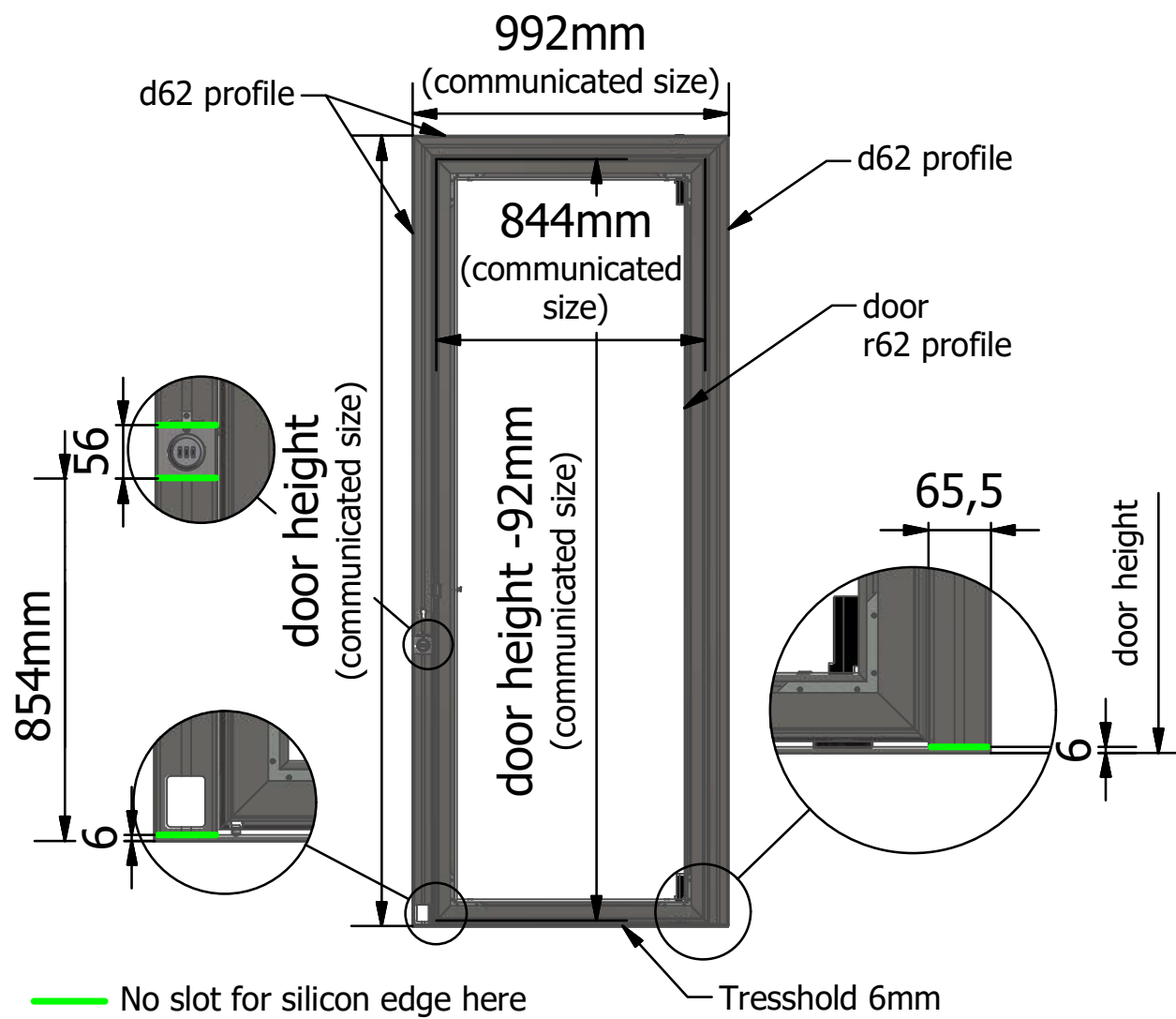

How to...

Determine textile dimensions

Double pivoting door (622 1984 +++)

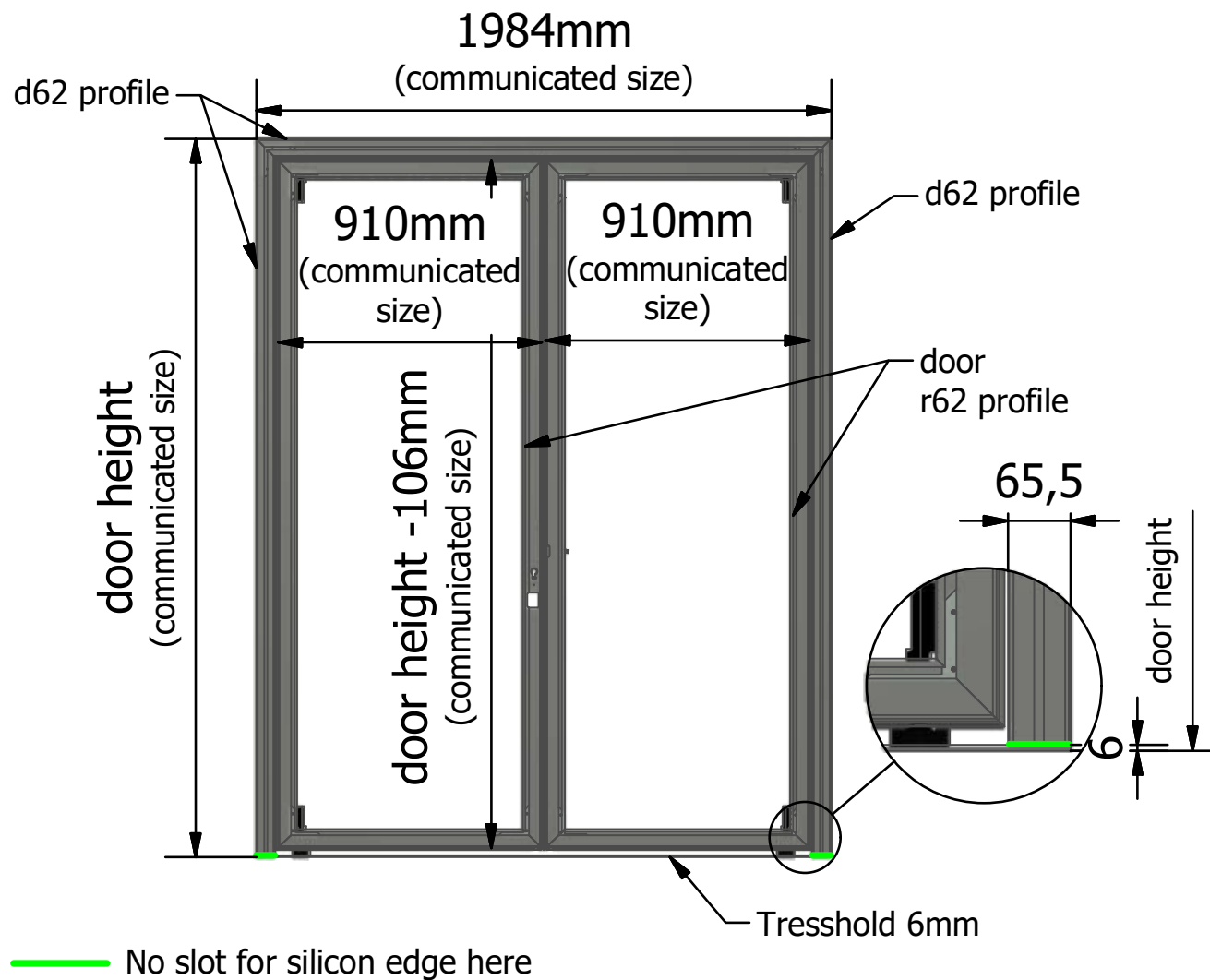

How to...

Determine textile dimensions

Pivoting (double) door

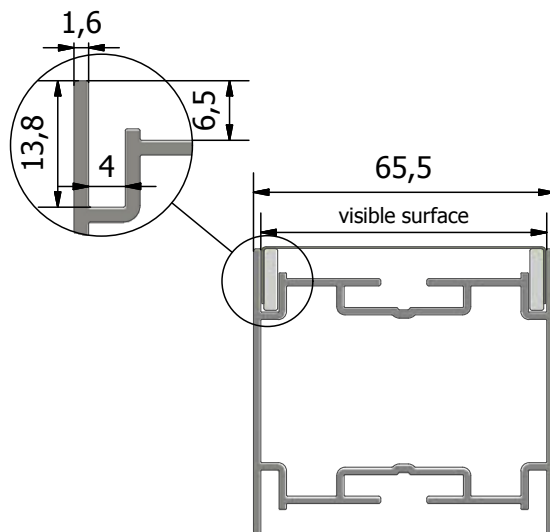
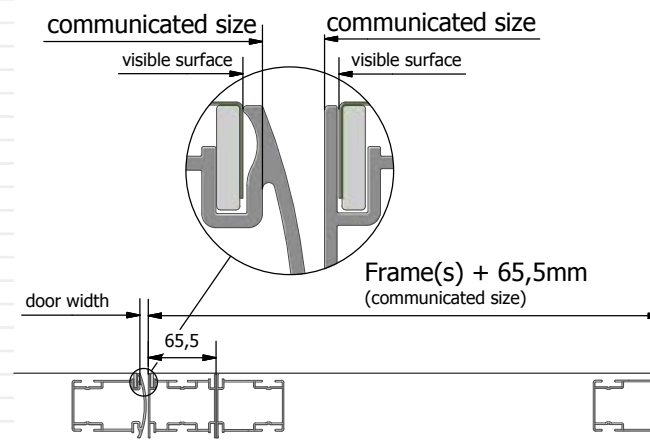
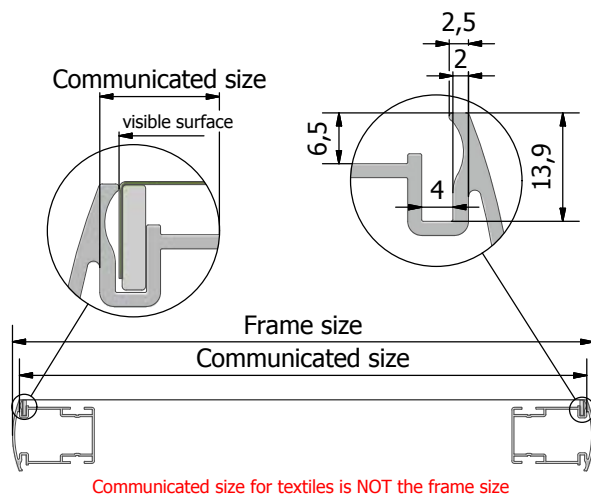

How to...

Determine textile dimensions

Lightscreen LS55S (715)

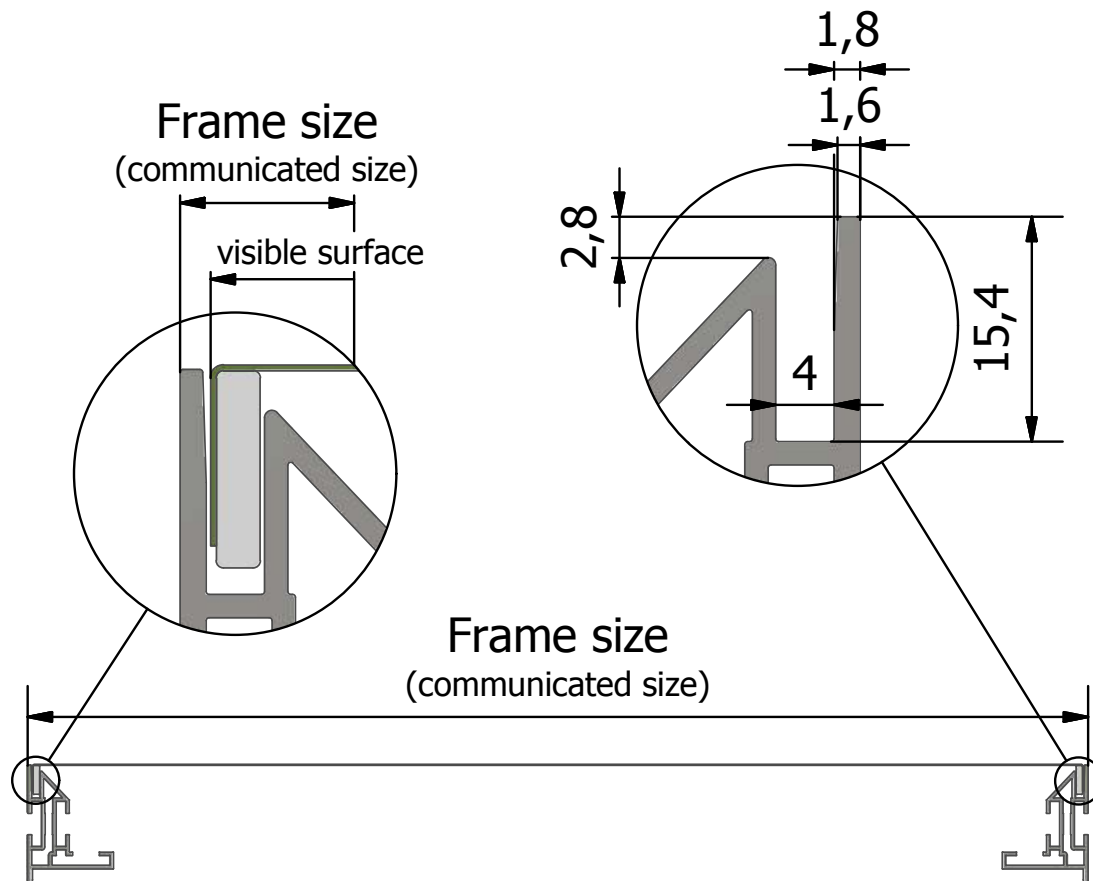

How to...

Determine textile dimensions

Lightscreen LS62S (719)

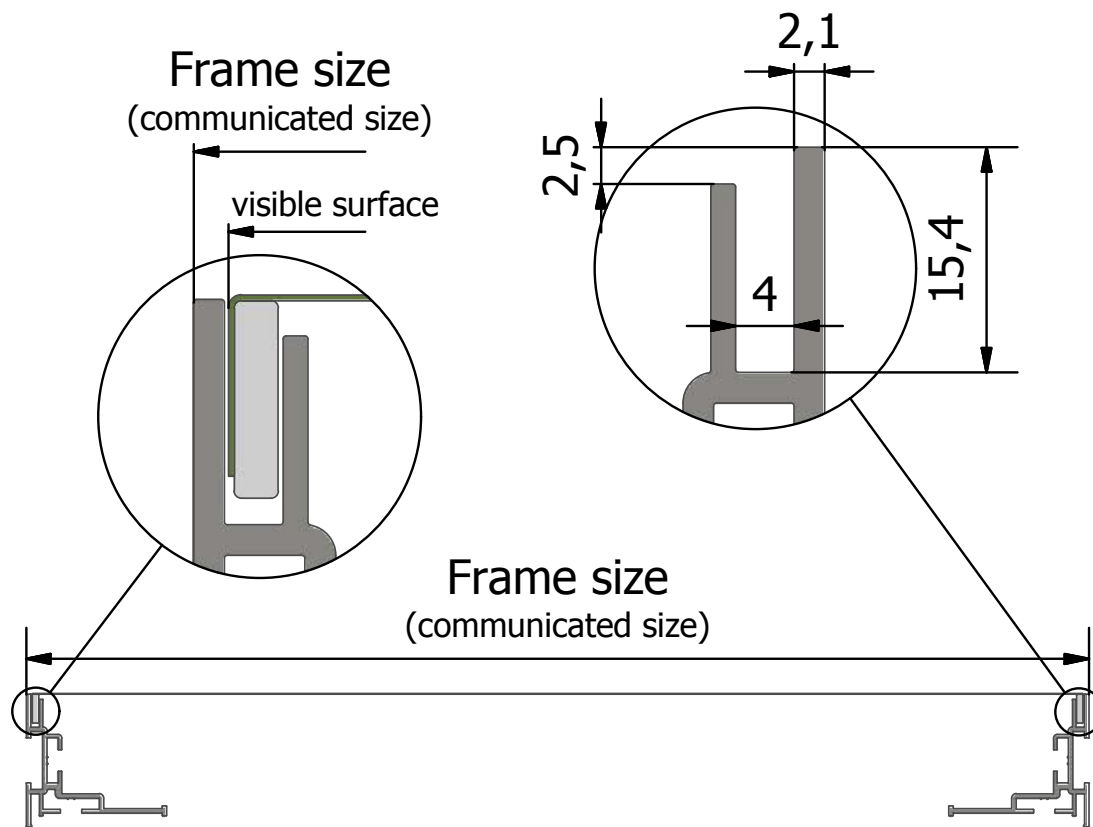

How to...

Determine textile dimensions

Lightscreen LS124S (724)

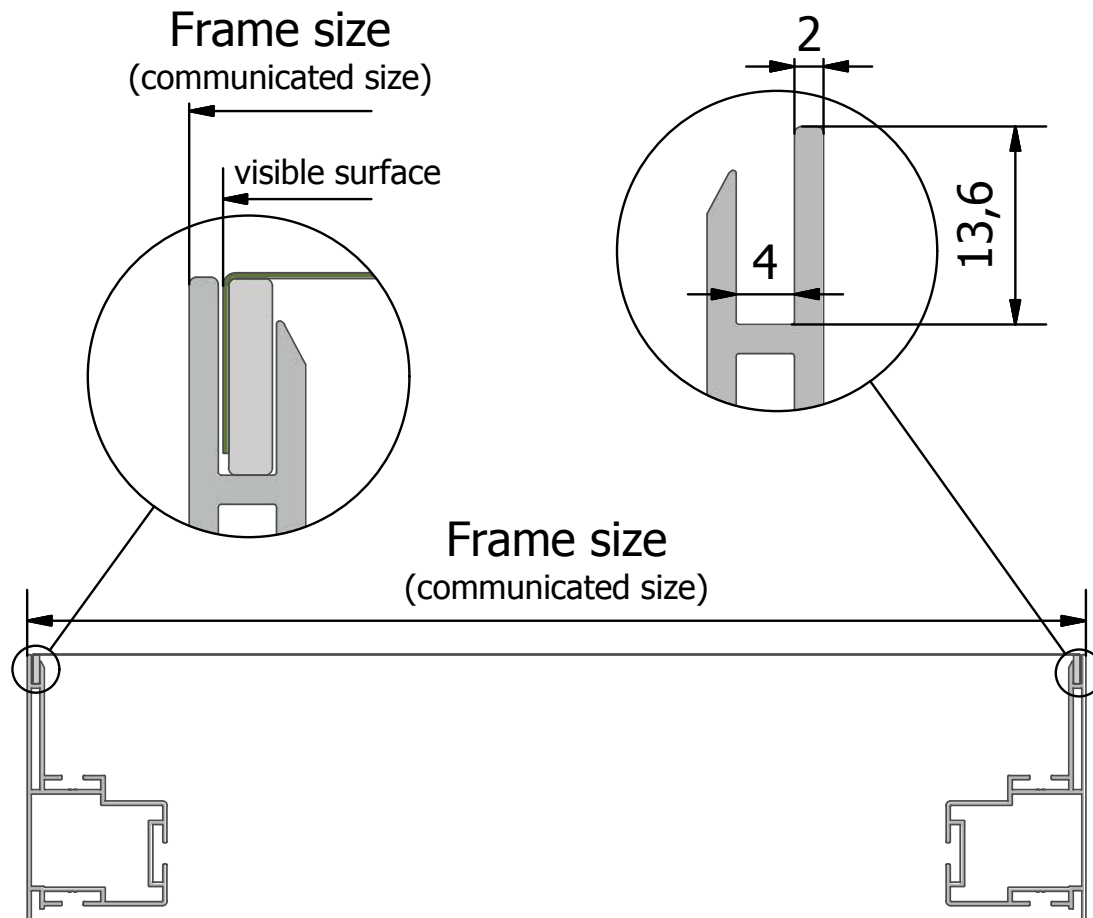

How to...

Determine textile dimensions

Lightscreen LS186D (786)

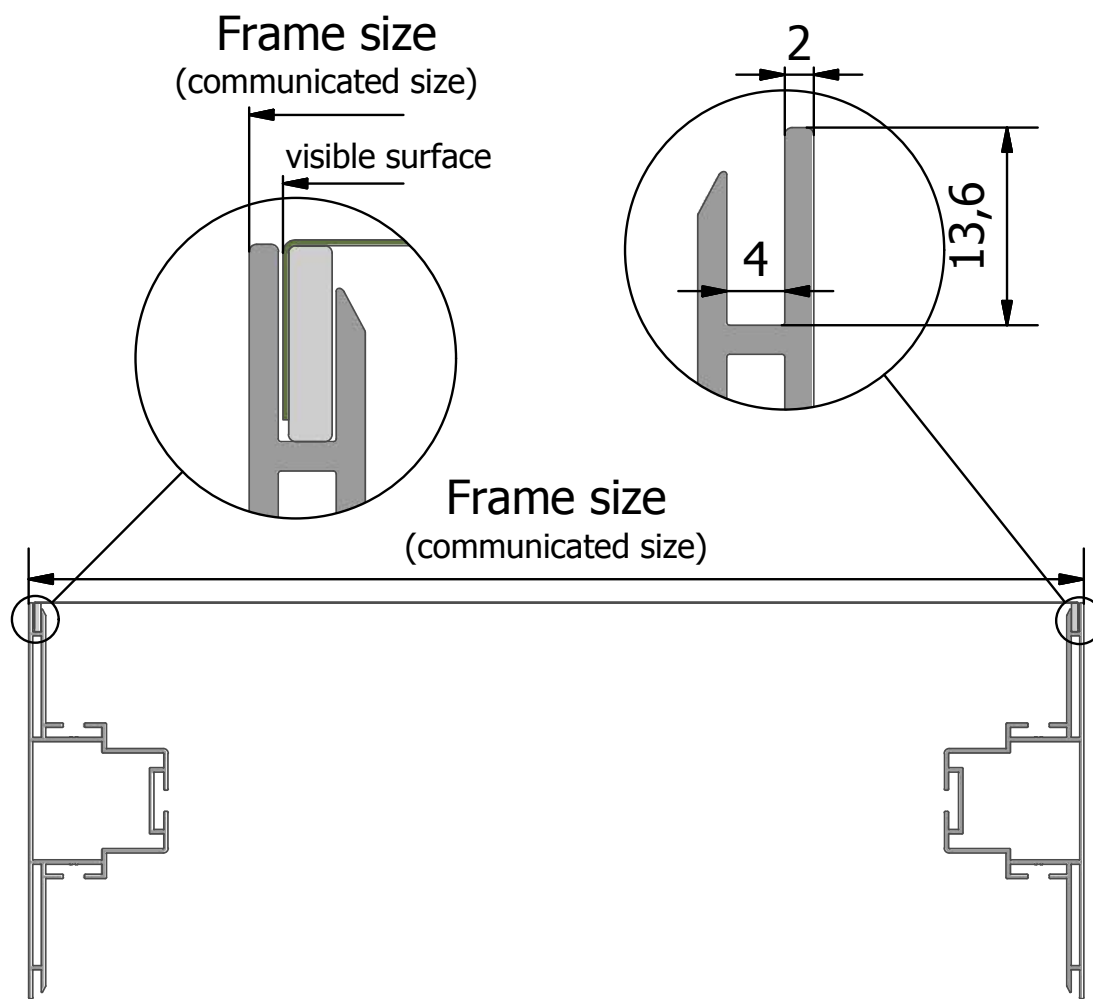

How to...

Determine textile dimensions

LEDskin® MKII (225 00 08 / 231 00 08 / 238 00 08)

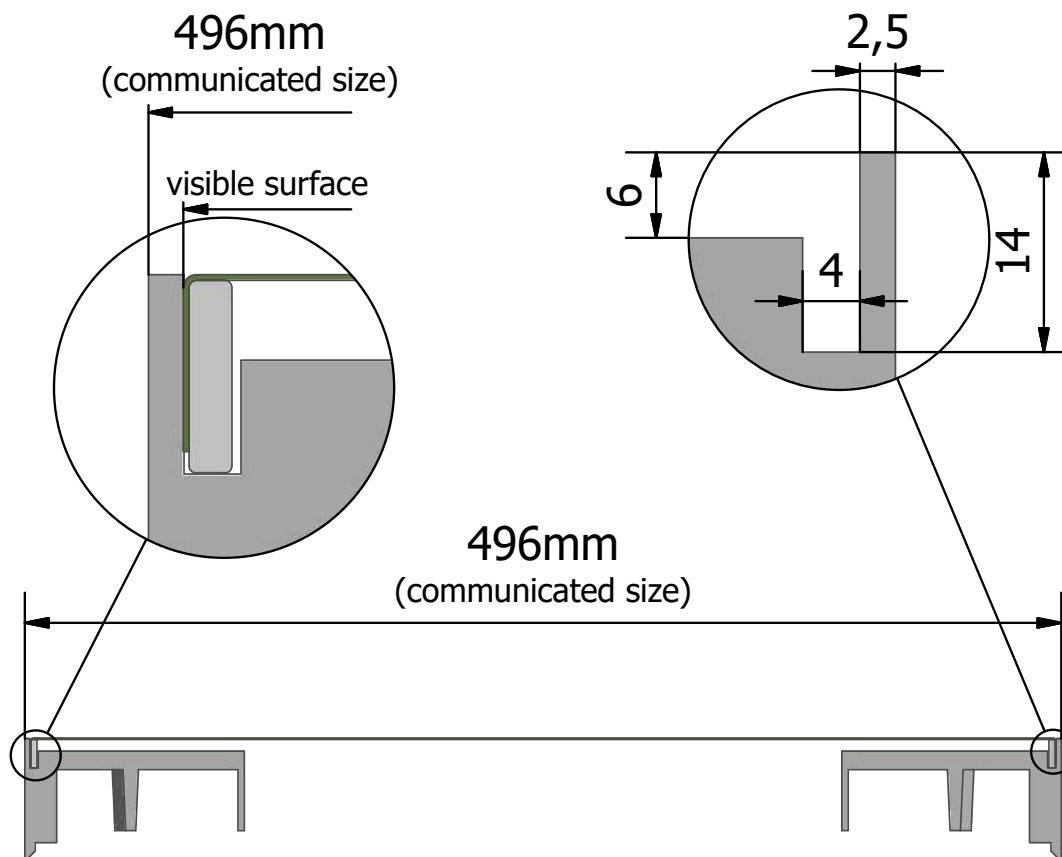

How to...

Determine textile dimensions

MOTIONskin® (730 +++++ +++++)

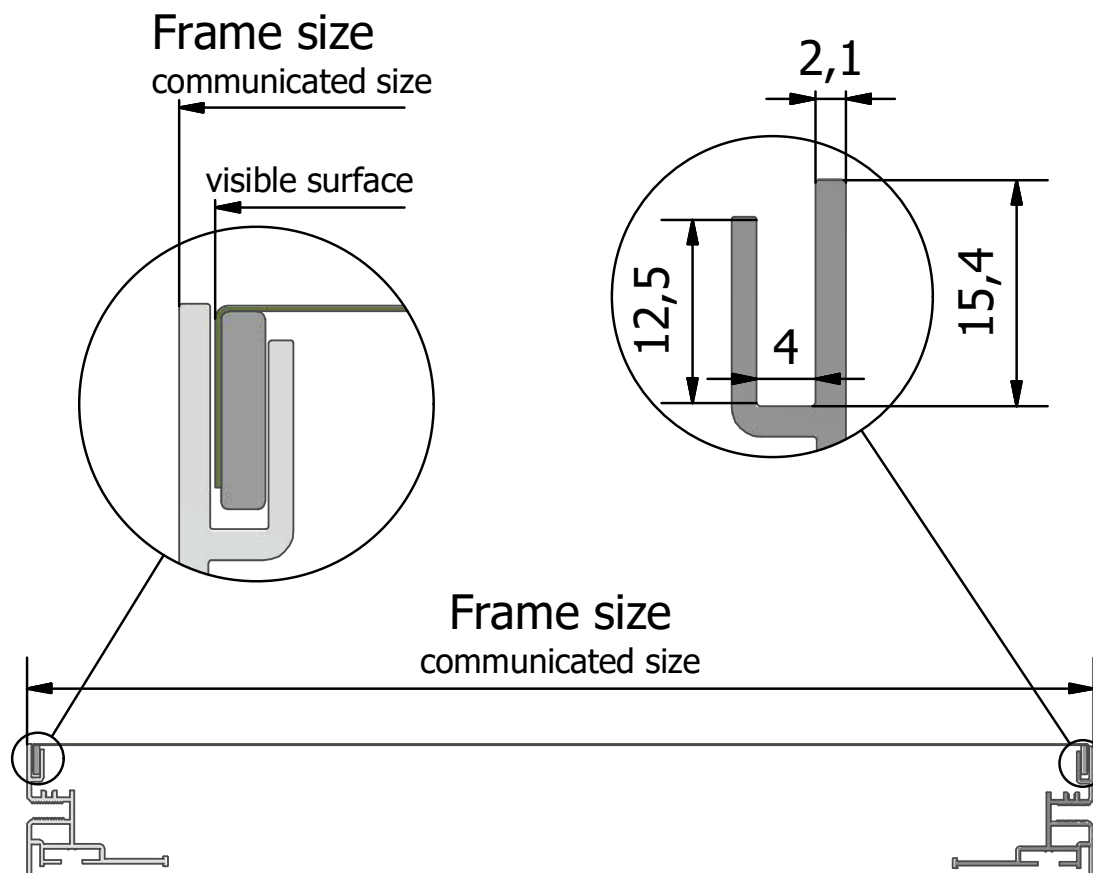

beMatrix[®]
re!nventing stand building systems

beMatrix head-office Belgium
*Wijnendalestraat 174
B - 8800 Roeselare
T. +32 51 20 07 50
F. +32 51 24 18 61
www.beMatrix.com*